

## BEST PRACTICE

LOCATION:	Construction/delivery site	ARTICLE YEAR	2021
ACTIVITY:	Lifting	COMPANY:	Invisible Connections Ltd
SUB ACTIVITY:	No Sub Activity Available	COMPANY LOCATION:	Companywide
BEST PRACTICE No:	BP2101	COMPANY TEL:	0000
COUNTRY OF ORIGIN:			

### TITLE



### Telescopic connectors for stairs and landings

### ARTICLE

The tradition of post-fixing steel support angles, to support precast stair landings, involves erecting a platform, drilling a large number of holes into the core wall and then using the crane to manoeuvre a heavy steel angle into position before site operatives fix it securely to the wall. This process is repeated at the other end of the landing before the landing and stairs can be installed. The entire process is repeated before each landing can be installed.

Operatives installing stairs and landings are therefore exposed to range of potential hazards such as fall from height, being struck by falling objects, exposure to dust, vibration, noise and trip hazards. The work is very time consuming and physically demanding, increasing the risk of fatigue.

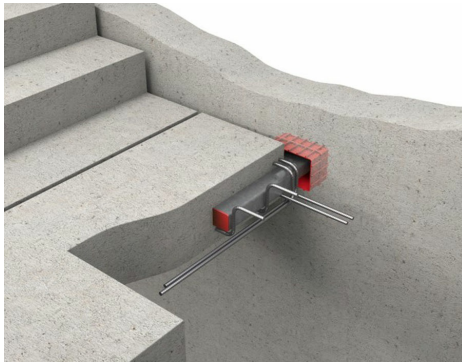

Invisible Connections has developed a system for the installation of precast stairways and landings that significantly reduces these risks based on telescopic connectors.

For more information see the **additional pdf**, email [sales@invisibleconnections.co.uk](mailto:sales@invisibleconnections.co.uk) or call +44 (0)1844 266000.

### ARTICLE IMAGES